

# Sym Cruisym 300 '17/18

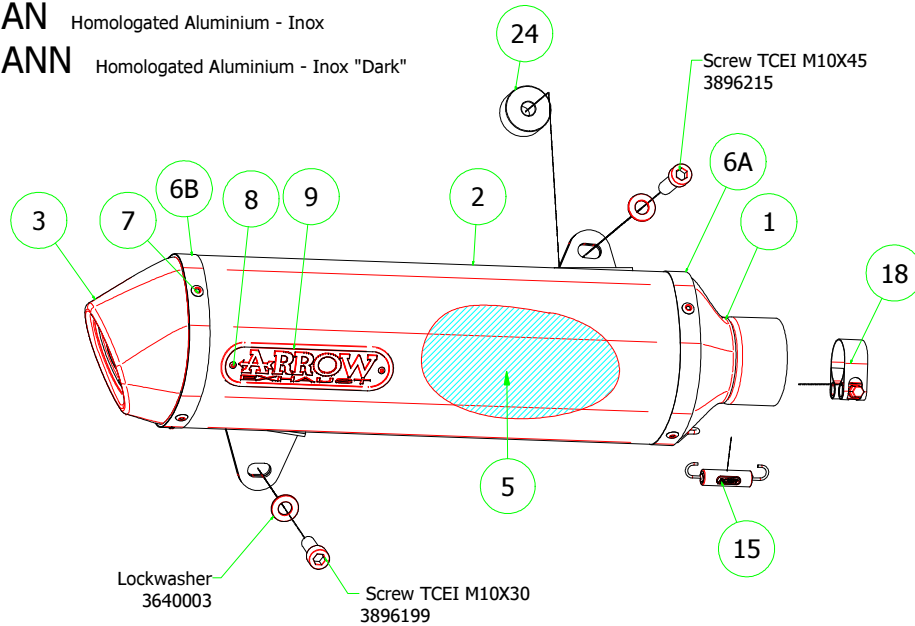

53522AN Homologated Aluminium - Inox

53522ANN Homologated Aluminium - Inox "Dark"



53069MI Racing Collector

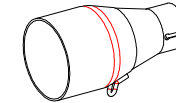

53522XN Homologated Nichrom

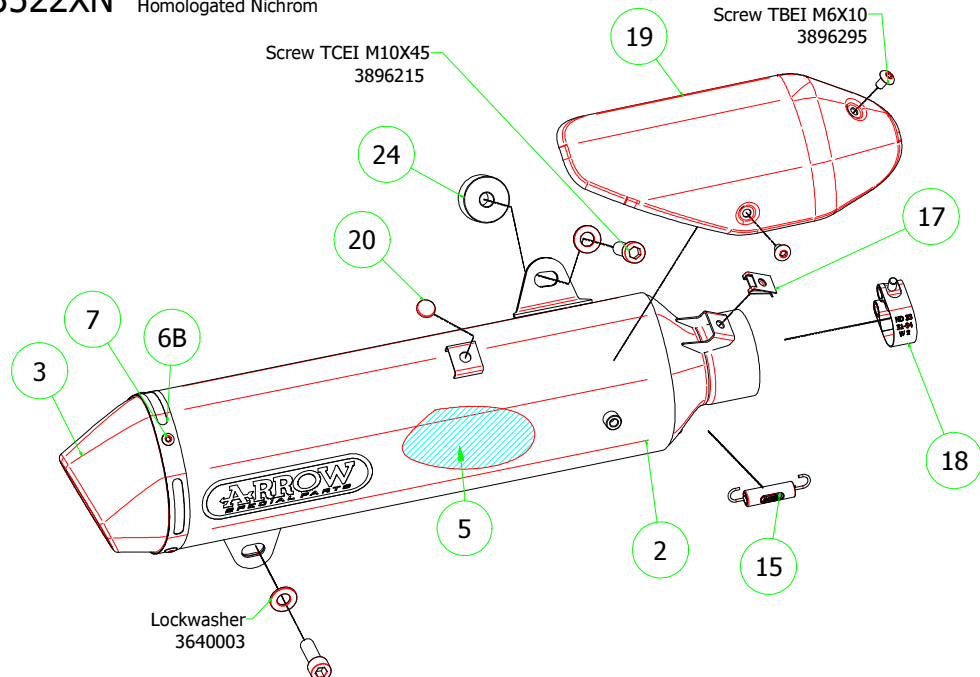

53069KZ Catalytic Homologated Collector

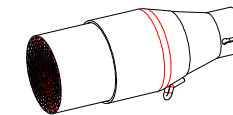

## PARTI DI RICAMBIO / SPARE PARTS

<b>ID</b>	<b>DESCRIZIONE / DESCRIPTION</b>	<b>53522AN cod</b>	<b>53522ANN cod</b>	<b>53522XN cod</b>
<b>1</b>	Assieme anteriore / <i>Front assembly</i>	<b>5035358</b>	<b>5035358</b>	
<b>2</b>	Corpo Marmitta / <i>Silencer Sleeve</i>	<b>5257493</b>	<b>5257494</b>	
<b>3</b>	Assieme Posteriore / <i>Rear assembly</i>	<b>5010042</b>	<b>5010042</b>	<b>5010042</b>
<b>5</b>	Materiale fonoassorbente / <i>Sound-absorbant material</i>	<b>5690184</b>	<b>5690184</b>	<b>5690184</b>
<b>6A</b>	Fascetta di Serraggio Anteriore / <i>Front Strap For Rivets</i>	<b>5495058</b>	<b>5495058</b>	
<b>6B</b>	Fascetta di Serraggio Posteriore / <i>Rear Strap For Rivets</i>	<b>5495456</b>	<b>5495456</b>	<b>5495490</b>
<b>7</b>	Rivetto inox mm 4.8 / <i>Stainless Steel 4.8 mm Rivet</i>	<b>3608011</b>	<b>3608011</b>	<b>3608011</b>
<b>8</b>	Rivetto allum.mm.3.0 / <i>Aluminium 3.0 mm Rivet</i>	<b>3608021</b>	<b>3608021</b>	
<b>9</b>	Targhetta Arrow / <i>Arrow Plate</i>	<b>5855109</b>	<b>5855109</b>	
<b>15</b>	Molla / <i>Spring</i>	<b>5281003</b>	<b>5281003</b>	<b>5281003</b>
<b>17</b>	Inserito Rapid Nut / <i>Caged nut insert</i>			<b>3245005</b>
<b>18</b>	Fascetta Stringitubo / <i>Hose clip</i>	<b>3080015</b>	<b>3080015</b>	<b>3080015</b>
<b>19</b>	Protezione / <i>Heat Shield</i>			<b>5683141</b>
<b>20</b>	Gommino / <i>Rubber</i>			<b>3240057</b>
<b>24</b>	Spessore / <i>Spacer</i>	<b>5180327</b>	<b>5180327</b>	<b>5180327</b>