

Box: 2x P LOCK 2 + SLEEVE

BIKE	Aprilia RSV 1000	PART NO.	EAP-52
YEAR	2003-2008	FIT KITS	OVAL Z039.11003
NOTES	Fits Factory/Mille R & Tuono	DB-Killer	SCEXDBK12 - (Type B)

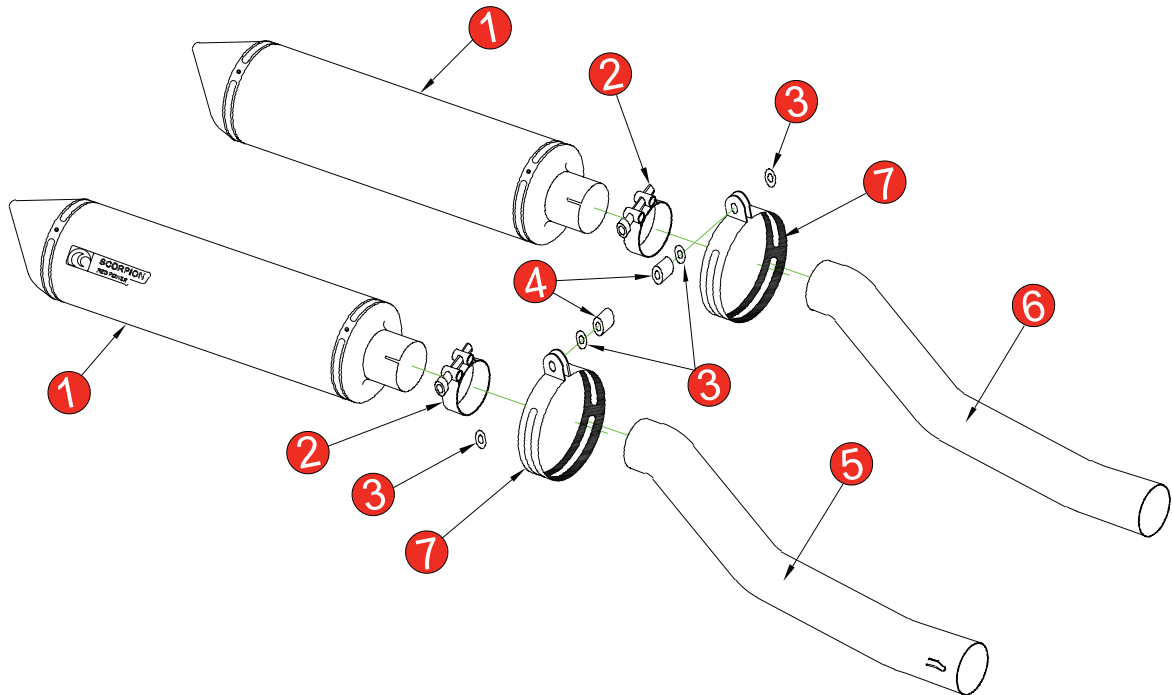

- 1 2 x 450mm Silencers (ESC50)
- 2 2 x 51-55mm Band Clamps (Z016.10002)
- 3 4 x m8 x 25mm Washers (Z017.10825)
- 4 2 x 10mm Aluminium Spacers (Z026.10004)
- 5 Connecting Pipe CP219
- 6 Connecting Pipe CP220
- 7 2 x Composite Silencer Straps (O-Z038.10088)

CLASSIFICATION	Closed Circuit Product
HOMOLOGATED	NO
ISSUE NO.	11
DATE	28/03/2022
AUTHORISED	S Shipley
CHECKED	

NOTE: ENSURE SCORPION SYSTEM IS CLEAR OF MOVING PARTS AND ALL ORIGINAL FUNCTIONS WORK CORRECTLY.



A) Remove original exhaust from bike, taking care to keep all original components in a safe place.

B) Refit Scorpion exhaust as per line diagram above.

C) When fitted take bike for a short ride to ensure all functions are correct.

D) When bike & exhaust are cool enough check all nuts and bolts are still secure.

SCORPION
RED POWER

scorpion-exhausts.com